

MSBH

 **STH®** for reflow soldering

 **MSL1**

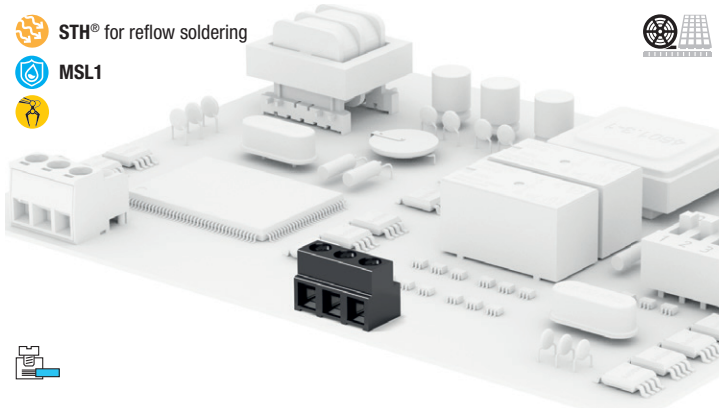

General data

Dimensional class:	low
Standard colour:	black
Pitches:	metric 5 mm, 10 mm (.197 in, .394 in) imperial 5.08 mm, 10.16 mm (.200 in, .400 in)
Screw dimension:	M3
Recommended/highest tightening torque:	0.5/0.6 Nm (4.42/5.31 lbf-in)
PCB thickness:	max. 2.4 mm (.094 in)
PCB hole diameter:	1.3 mm (.051 in)
Stripping length	5 ÷ 6 mm (.197 ÷ .24 in)
Operating temperature range	-40 °C ÷ +105 °C (-40 °F ÷ +221 °F)
Contact resistance	<15 mΩ
Insulation resistance	>10 ⁹ Ω (500V DC)
Insulating material group:	I (CTI ≥ 600V)

Certifications

UL (n. E167473)
300 V - 13.5 A (*), 10 A (**) - 30÷16 AWG - 6 lbf-in for 5 mm, 5.08 mm pitch
600 V - 13.5 A (*), 10 A (**) - 30÷16 AWG - 6 lbf-in for 10 mm and 10.16 mm pitch
*factory wiring - **field wiring

Data according to

IEC EN 60947-7-4
250 V - T 110 - 17.5 A - 1.5 mm² solid (13.5 A - 1 mm² stranded) for 5 mm and 5.08 mm pitch
750 V - T 110 - 17.5 A - 1.5 mm² solid (13.5 A - 1 mm² stranded) for 10 mm and 10.16 mm pitch

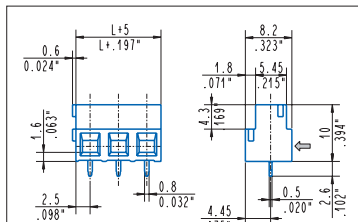

Straight, modular

MSBH_0M1-ON 2 ÷ 12 poles, 5 mm / .197" pitch
MSBH_0M2-ON 1 ÷ 6 poles, 10 mm / .394" pitch

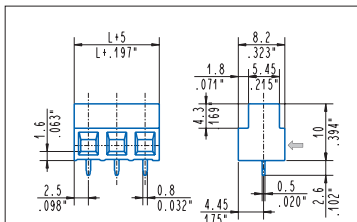

Straight, side stackable

MSBH_001-ON 2 ÷ 12 poles, 5 mm / .197" pitch
MSBH_002-ON 2 ÷ 6 poles, 10 mm / .394" pitch
MSBH_005-ON 2 ÷ 5 poles, 5.08 mm / .200" pitch
MSBH_006-ON 2 ÷ 3 poles, 10.16 mm / .400" pitch

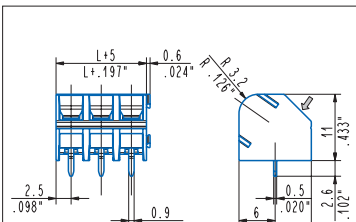

55°, modular

MSBH_041-ON 2÷5 poles, 5 mm / .197" pitch
MSBH_042-ON 1÷3 poles, 10 mm / .394" pitch
MSBH_045-ON 2÷16 poles, 5.08 mm / .200" pitch
MSBH_046-ON 1÷8 poles, 10.16 mm / .400" pitch

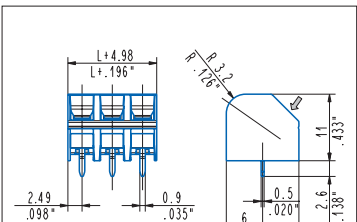

55°, side stackable

MSBH_061-ON 2÷5 poles, 5 mm / .197" pitch
MSBH_062-ON 2÷3 poles, 10 mm / .394" pitch
MSBH_065-ON 2÷16 poles, 5.08 mm / .200" pitch
MSBH_066-ON 2÷8 poles, 10.16 mm / .400" pitch

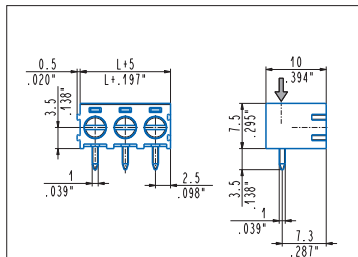

90° "T" version, modular

MSBH_T01-ON 2÷25 poles, 5 mm / .197" pitch
MSBH_T02-ON 1÷13 poles, 10 mm / .394" pitch
MSBH_T05-ON 2÷8 poles, 5.08 mm / .200" pitch
MSBH_T06-ON 1÷4 poles, 10.16 mm / .400" pitch

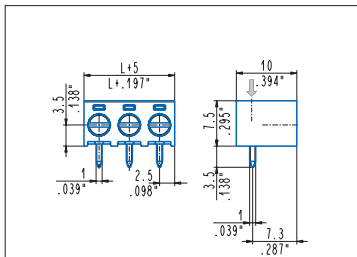

90° "T" version, side stackable

MSBH_TA1-ON 2÷25 poles, 5 mm / .197" pitch
MSBH_TA2-ON 2÷13 poles, 10 mm / .394" pitch
MSBH_TA5-ON 2÷8 poles, 5.08 mm / .200" pitch
MSBH_TA6-ON 2÷4 poles, 10.16 mm / .400" pitch