

MSP

Traditional for wave soldering

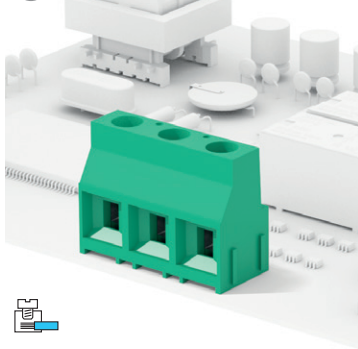

MSPH

STH® for reflow soldering

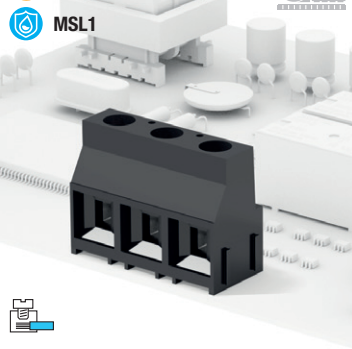

MSL1

General data

Dimensional class:	high
Standard colour:	green for wave soldering, black for reflow soldering
Pitches:	imperial 6.35, 7.62, 9.52, 12.7 (.250, .300, .375, .500 in)
Screw dimension:	M3.5
Recommended/highest tightening torque:	0.8/1 Nm (7/8.85 lbf-in)
PCB thickness:	max. 4 mm (.157 in)
PCB hole diameter:	min. 1.4 mm (.055 in)
Stripping length:	7 ÷ 8 mm (.28 ÷ .31 in)
Operating temperature range:	-40 °C ÷ +105 °C (-40 °F ÷ +221 °F)
STH operating temperature range:	-40 °C ÷ +105 °C (-40 °F ÷ +221 °F)
Contact resistance:	<15 mΩ
Insulation resistance:	>10 ⁹ Ω (500V DC)
Insulating material group:	I (CTI ≥ 600V)

Certifications

UL (n. E167473)

300 V - 30 A - 30±10 AWG - 7 lbf-in for 6.35 mm 7.62 mm 9.52 mm pitch
600 V - 30 A - 30±10 AWG - 7 lbf-in for 12.7 mm pitch

For **low ampere** rating version

300 V - 24 A - 30±10 AWG - 7 lbf-in for 6.35 mm 7.62 mm pitch
600 V - 24 A - 30±10 AWG - 7 lbf-in for 9.52 mm 12.7 mm pitch

VDE (n. 40021758)

450 V - T 110 - 32 A - 4 mm² for 6.35 mm pitch
750 V - T 110 - 32 A - 4 mm² for 9.52 mm pitch

IMQ (n. CA02.00899) for traditional product

450 V - T 110 - 41 A - 6 mm² solid (32 A - 4 mm² stranded) for 6.35 mm pitch
750 V - T 110 - 41 A - 6 mm² solid (32 A - 4 mm² stranded) for 9.52 mm pitch

CSA (n. LR102896) for traditional product

300 V - 32 A - 30±10 AWG for 6.35 mm pitch
600 V - 32 A - 30±10 AWG for 9.52 mm pitch

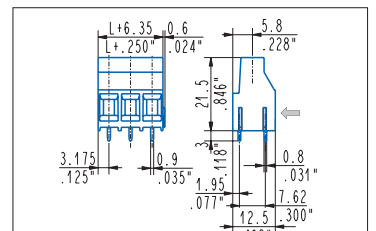

Straight, modular, double pin

- MSP_DMS** - 2÷5 poles, 6.35 mm / .250" pitch
 - MSP_DM7** - 2÷3 poles, 7.62 mm / .300" pitch
 - MSP_DMN** - 2÷3 poles, 9.52 mm / .375" pitch
 - MSP_DMU** - 1÷3 poles, 12.7 mm / .500" pitch
 - MSPH_DMS-ON** 2÷5 poles, 6.35 mm / .250" pitch
 - MSPH_DM7-ON** 2÷3 poles, 7.62 mm / .300" pitch
 - MSPH_DMN-ON** 2÷3 poles, 9.52 mm / .375" pitch
- max 5 poles can be combined

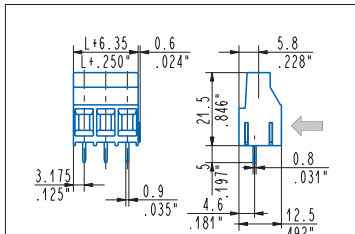

Straight, modular

- MSP_00S** - 2÷5 poles, 6.35 mm / .250" pitch
 - MSP_007** - 2÷3 poles, 7.62 mm / .300" pitch
 - MSP_00N** - 2÷3 poles, 9.52 mm / .375" pitch
 - MSP_00U** - 1÷3 poles, 12.7 mm / .500" pitch
 - MSPH_00S-ON** 2÷5 poles, 6.35 mm / .250" pitch
 - MSPH_007-ON** 2÷3 poles, 7.62 mm / .300" pitch
 - MSPH_00N-ON** 2÷3 poles, 9.52 mm / .375" pitch
- max 5 poles can be combined

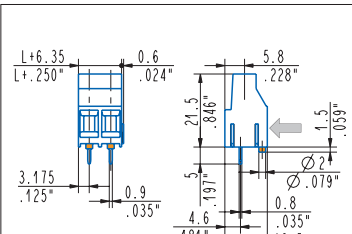

Straight, modular, pegs

- MSP_00S-0000P** 2÷5 poles, 6.35 mm .250" pitch
- MSP_007-0000P** 2÷3 poles, 7.62 mm .300" pitch
- MSP_00N-0000P** 2÷3 poles, 9.52 mm .375" pitch
- MSP_00U-0000P** 1÷3 poles, 12.7 mm .500" pitch

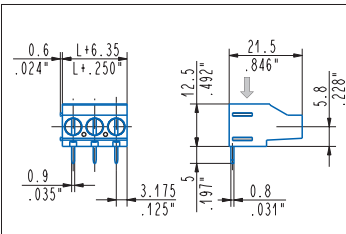

90°, modular

- MSP_09S** - 2÷5 poles, 6.35 mm / .250" pitch
 - MSP_097** - 2÷3 poles, 7.62 mm / .300" pitch
 - MSP_09N** - 2÷3 poles, 9.52 mm / .375" pitch
 - MSP_09U** - 1÷3 poles, 12.7 mm / .500" pitch
 - MSPH_09S-ON** 2÷5 poles, 6.35 mm / .250" pitch
 - MSPH_097-ON** 2÷3 poles, 7.62 mm / .300" pitch
 - MSPH_09N-ON** 2÷3 poles, 9.52 mm / .375" pitch
- max 5 poles can be combined

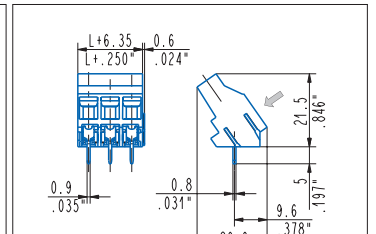

35°, modular

- MSP_04S** - 2÷3 poles, 6.35 mm / .250" pitch
 - MSP_04N** - 2÷3 poles, 9.52 mm / .375" pitch
 - MSP_04U** - 1÷3 poles, 12.7 mm / .500" pitch
 - MSPH_04S-ON** - 2÷3 poles, 6.35 mm / .250" pitch
 - MSPH_04N-ON** - 2÷3 poles, 9.52 mm / .375" pitch
- max 5 poles can be combined

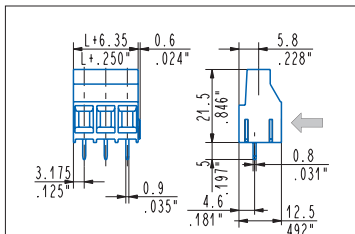

Straight, modular, low ampere rating

- MSP_00S-0000E** 2÷5 poles, 6.35 mm .250" pitch
- MSP_007-0000E** 2÷3 poles, 7.62 mm .300" pitch
- MSP_00N-0000E** 2÷3 poles, 9.52 mm .375" pitch
- MSP_00U-0000E** 1÷3 poles, 12.7 mm .500" pitch

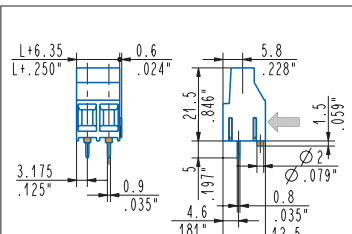

Straight, modular, low ampere rating, pegs

- MSP_00S-0000EP** 2÷5 poles, 6.35 mm .250" pitch
- MSP_007-0000EP** 2÷3 poles, 7.62 mm .300" pitch
- MSP_00N-0000EP** 2÷3 poles, 9.52 mm .375" pitch
- MSP_00U-0000EP** 1÷3 poles, 12.7 mm .500" pitch

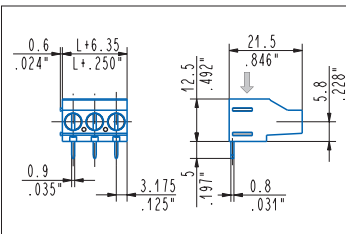

90°, modular, low ampere rating

- MSP_09S-0000E** 2÷5 poles, 6.35 mm .250" pitch
- MSP_097-0000E** 2÷3 poles, 7.62 mm .300" pitch
- MSP_09N-0000E** 2÷3 poles, 9.52 mm .375" pitch
- MSP_09U-0000E** 1÷3 poles, 12.7 mm .500" pitch

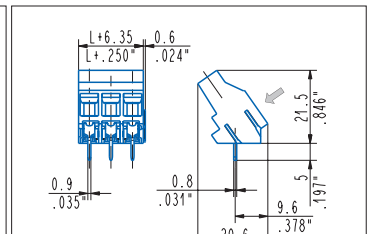

35°, modular, low ampere rating

- MSP_04S-0000E** 2÷3 poles, 6.35 mm / .250" pitch
- MSP_04N-0000E** 2÷3 poles, 9.52 mm / .375" pitch
- MSP_04U-0000E** 1÷3 poles, 12.7 mm / .500" pitch