

### MSSH

**STH®** for reflow soldering

**MSL1**

For resined PCB

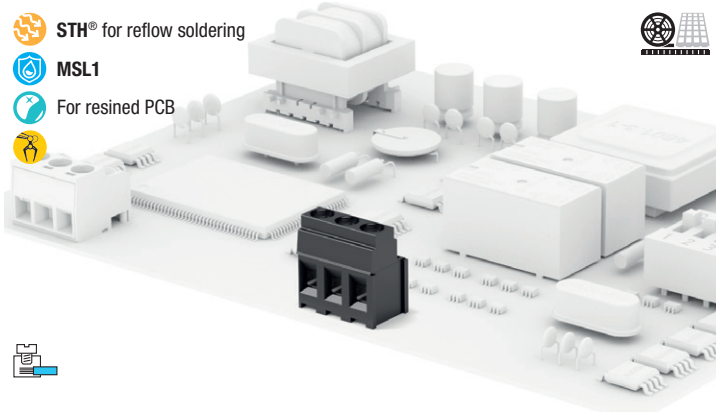

#### General data

<b>Dimensional class:</b>	medium
<b>Standard colour:</b>	black
<b>Pitches:</b>	metric 5 mm, 7.5 mm, 10 mm (.197 in, .295 in, .394 in) imperial 7.62 mm (.300 in)
<b>Screw dimension:</b>	M3
<b>Recommended/highest tightening torque:</b>	0.5/0.6 Nm (4.42/5.31 lbf-in)
<b>PCB thickness:</b>	max. 2.4 mm (.094 in)
<b>PCB hole diameter:</b>	1.5 mm (.059 in)
<b>Stripping length:</b>	5.5 ÷ 6.5 mm (.22 ÷ .26 in)
<b>Operating temperature range:</b>	-40 °C ÷ +105 °C (-40 °F ÷ +221 °F)
<b>Contact resistance:</b>	<15 mΩ
<b>Insulation resistance:</b>	>10 <sup>9</sup> Ω (500V DC)
<b>Insulating material group:</b>	I (CTI ≥ 600V)

#### Data according to

##### UL 1059

300 V - 17.5 A - 30÷12 AWG - 7 lbf-in for 5 mm, 7.5 mm and 7.62 mm pitch  
600 V - 17.5 A - 30÷12 AWG - 7 lbf-in for 10 mm pitch

##### IEC EN 60947-7-4

250 V - 24 A - 2.5 mm<sup>2</sup> - T 110 for 5 mm pitch  
750 V - 24 A - 2.5 mm<sup>2</sup> - T 110 for 7.5 mm, 7.62 mm, 10 mm pitch

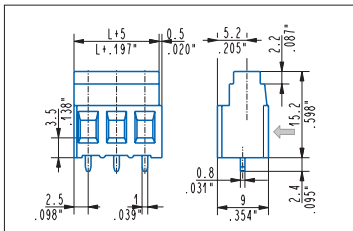

#### Straight, modular

**MSSH\_0M1-ON** 2÷25 poles, 5 mm / .197" pitch  
**MSSH\_0M3-ON** 2÷4 poles, 7.5 mm / .295" pitch  
**MSSH\_0M2-ON** 1÷13 poles, 10 mm / .394" pitch

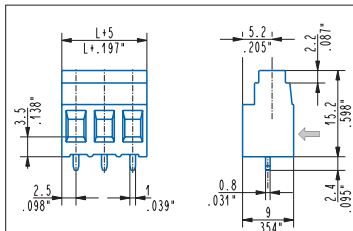

#### Straight, side stackable

**MSSH\_001-ON** 2÷25 poles, 5 mm / .197" pitch  
**MSSH\_003-ON** 2÷4 poles, 7.5 mm / .295" pitch  
**MSSH\_002-ON** 2÷13 poles, 10 mm / .394" pitch  
**MSSH\_007-ON** 2÷3 poles, 7.62 mm / .300" pitch

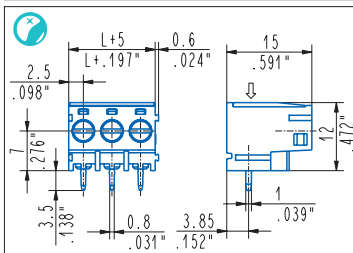

#### 90° "T" version, modular

**MSSH\_TM1-ON** 2÷5 poles, 5 mm / .197" pitch

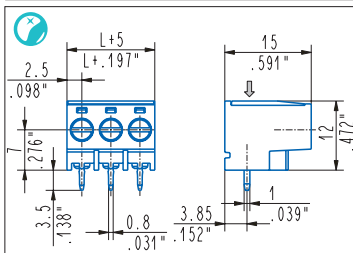

#### 90° "T" version, side stackable

**MSSH\_TA1-ON** 2÷5 poles, 5 mm / .197" pitch